

WIA Annual Program Planning Data 2014



WIA Annual Program Planning Data 2014

For additional information contact:
Office of Labor Market Information
Mary Findlay 402-471-9915
Mary.findlay@nebraska.gov



NEBRASKA
DEPARTMENT OF LABOR

Fund Allocations

A. Adults and Youth

Fund Allocations
Adults and Youth

1. Areas of Substantial Unemployment

The table below displays the number of unemployed individuals residing in areas of substantial unemployment in each designated area and the share of those individuals in each local area.

Local Area	Number of Unemployed Individuals in Areas of Substantial Unemployment	Percent of State	Percent of Region
Omaha #	11,672	62.0027%	
Lincoln	3,427	18.2045%	
Greater Nebraska	3,726	19.7928%	
Region I	665		17.848%
Region II	351		9.420%
Region III	501		13.446%
Region IV	391		10.494%
Region V #	1,818		48.792%
Nebraska	18,825	100.0000%	100.000%

Note: # Includes portions of Northeast Nebraska ASU

Data Source:

Local Area Unemployment Statistics (LAUS) Program and prepared in accordance with the Bureau of Labor Statistics LAUS Technical Memorandum No. S-13-17

Time Period the Data Represent: July 1, 2012 through June 30, 2013

Validity Factor: Excellent

2. Excess Number of Unemployed Individuals

Relative excess number of unemployed individuals who reside in each designated area as compared to the total excess number of unemployed individuals in all designated areas of the state.

There are no excess individuals in the state.

Data Source:

Local Area Unemployment Statistics (LAUS) Program

Time Period the Data Represent: July 1, 2012 through June 30, 2013

Validity Factor: Excellent

3. Excess Number of Unemployed Individuals in Areas of Substantial Unemployment

The table below displays the number of unemployed individuals in excess of 4.5 percent of the civilian labor force, who reside in areas of substantial unemployment in each designated area and the share of those individuals in each local area.

Local Area	Excess Number of Unemployed Individuals in Areas of Substantial Unemployment	Percent of State	Percent of Region
Omaha #	3,546	61.22%	
Lincoln	1,050	18.13%	
Greater Nebraska	1,196	20.65%	
Region I	206		17.224%
Region II	107		8.946%
Region III	340		28.428%
Region IV	119		9.950%
Region V #	424		35.452%
Nebraska	5,792	100.00%	100.000%

Note: # Includes portions of Northeast Nebraska ASU

Data Source:

Local Area Unemployment Statistics (LAUS) Program and prepared in accordance with the Bureau of Labor Statistics LAUS Technical Memorandum No. S-13-17

Time Period the Data Represent: July 1, 2012 through June 30, 2013

Validity Factor: Excellent

4. Economically Disadvantaged Adult Populations

The table below displays the number of economically disadvantaged adults ages 22 – 72 within each designated area and the share of those individuals in each local area and regions of Greater Nebraska.

Note: Poverty status was determined for all persons except institutionalized persons, persons in military group quarters, and persons in college dormitories.

Local Area	Number of Economically Disadvantaged Adults Ages 22-72	Percent of State	Percent of Region
Omaha	37,800	35.37%	
Lincoln	19,945	18.66%	
Greater Nebraska	49,131	45.97%	
Region I	6,359		12.94%
Region II	6,547		13.33%
Region III	13,739		27.96%
Region IV	8,783		17.88%
Region V	13,703		27.89%
Nebraska	106,876	100.00%	100.00%

Data Source:

American Community Survey special tabulation data obtained by ETA from the Census Bureau based on the five-year moving average using data collected between January 1, 2006 and December 31, 2010 per TEGL 21-12, March 26, 2013

Time Period the Data Represent: 2011

Validity Factor: Good

5. Economically Disadvantaged Youth Populations

The table below displays the number of economically disadvantaged youth ages 16 - 21 within each designated area and the share of those individuals in each local area and regions of Greater Nebraska.

Note: Poverty is not defined for people in military barracks, institutional group quarters, or for unrelated individuals under age 15 (such as foster children). They are excluded from the poverty universe – that is they are considered neither as “poor” or “nonpoor.”

Local Area	Number of Economically Disadvantaged Youth Ages 16-21	Percent of State	Percent of Region
Omaha	11,975	30.9560%	
Lincoln	10,935	28.2675%	
Greater Nebraska	15,774	40.7765%	
Region I	2,349		14.892%
Region II	1,432		9.078%
Region III	4,474		28.363%
Region IV	2,795		17.719%
Region V	4,724		29.948%
Nebraska	38,684	100.0000%	100.000%

Data Source:

American Community Survey special tabulation data obtained by ETA from the Census Bureau based on the five-year moving average using data collected between January 1, 2006 and December 31, 2010 per TEGL 21-12, March 26, 2013

Time Period the Data Represent: 2011

Validity Factor: Good

6. Unemployment Rate for Each Designated Area

Average unemployment rate from July 1, 2012 through June 30, 2013 for each local area.

Local Area	Unemployment Rate
Omaha	4.3%
Lincoln	3.6%
Greater Nebraska	3.7%
Region I	4.0%
Region II	3.5%
Region III	3.3%
Region IV	4.1%
Region V	3.8%
Nebraska	3.9%

Data Source:

Local Area Unemployment Statistics (LAUS) Program

Time Period the Data Represent: July 1, 2012 through June 30, 2013

Validity Factor: Excellent

7. Population of Individuals Age 18 Years and Older

The table below displays the population of individuals age 18 and older within each designated area and the share of those individuals in each local area and regions of Greater Nebraska.

Local Area	Population of Individuals Age 18 and Older	Percent of State	Percent of Region
Omaha	526,590	37.83%	
Lincoln	241,532	17.35%	
Greater Nebraska	623,998	44.82%	
Region I	67,025		10.741%
Region II	84,389		13.524%
Region III	171,739		27.522%
Region IV	115,508		18.511%
Region V	185,337		29.702%
Nebraska	1,392,120	100.00%	100.000%

Data Source:

U. S. Census Bureau Annual Estimates of the Resident Population for Selected Age Groups by Sex for the United States, States, Counties, and Puerto Rico Commonwealth and Municipios: April 1, 2010 to July 1, 2012

Time Period the Data Represent: 2012

Validity Factor: Excellent

8. Youth Ages 16 – 21 in the Civilian Labor Force

The table below displays the number of individuals in the civilian labor force who are ages 16 – 21 in each local area and the share of those individuals in each local area and regions of Greater Nebraska.

Local Area	Youth Ages 16-21 in the Civilian Labor Force	Percent of State	Percent of Region
Omaha	36,142	36.39%	
Lincoln	21,929	22.08%	
Greater Nebraska	41,240	41.53%	
Region I	4,433		10.749%
Region II	4,654		11.285%
Region III	12,174		29.520%
Region IV	7,115		17.253%
Region V	12,864		31.193%
Nebraska	99,311	100.00%	100.000%

Data Source:

U.S. Census American Community Survey 2008-2012 Estimates Table B23001 Sex by Age by Employment Status for the Population 16 Years and Over

Time Period the Data Represent: 2012

Validity Factor: Good

Fund Allocations
Adults and Youth

9. Adults Ages 22 - 72 in the Civilian Labor Force

The table below displays the number of individuals in the civilian labor force who are ages 22-72 in each local area and the share of those individuals in each local area and regions of Greater Nebraska.

Local Area	Adults Ages 22-72 in the Civilian Labor Force	Percent of State	Percent of Region
Omaha	346,007	38.95%	
Lincoln	152,755	17.20%	
Greater Nebraska	389,584	43.85%	
Region I	41,132		10.558%
Region II	53,037		13.614%
Region III	108,463		27.841%
Region IV	69,931		17.950%
Region V	117,021		30.037%
Nebraska	888,346	100.00%	100.000%

Data Source:

U.S. Census American Community Survey 2008 - 2012 Estimates Table B23001 Sex by Age by Employment Status for the Population 16 Years and Over

Time Period the Data Represent: 2012

Validity Factor: Good

Fund Allocations

B. Dislocated Workers

Fund Allocations
Dislocated Workers

1. Individuals Unemployed 15 Weeks or More

The table below displays the number of individuals who were unemployed 15 weeks or more in each local area and the share of those individuals in each local area and regions of Greater Nebraska.

Local Area	Number of Individuals Unemployed 15 Weeks or More	Percent of State	Percent of Region
Omaha	9,920	43.49%	
Lincoln	3,625	15.89%	
Greater Nebraska	9,263	40.61%	
Region I	953		10.2882%
Region II	1,226		13.2355%
Region III	2,335		25.2078%
Region IV	1,917		20.6952%
Region V	2,832		30.5733%
Nebraska	22,808	100.00%	100.000%

Data Source:

Nebraska Department of Labor Unemployment Insurance Benefit Files

Time Period the Data Represent: July 1, 2012 through June 30, 2013

Validity Factor: Excellent

Fund Allocations
Dislocated Workers

2. Dislocated Workers

The table below displays the number of dislocated workers (including farmers and ranchers) in each local area and the share of those individuals in each local area and regions of Greater Nebraska. For the purpose of this distribution criteria, the number of dislocated workers shall be calculated using plant closings, mass layoff data and State of Nebraska Department of Revenue net farm earnings less than or equal to \$14,484 on the Schedule F for farm income for calendar year 2009 and aged by population change.

Region Name	Dislocated Workers	Percent of State	Percent of Region
Omaha	3,474	9.05%	
Lincoln	2,728	7.10%	
Greater Nebraska	32,205	83.85%	
Region I	3,736		11.601%
Region II	5,412		16.805%
Region III	7,810		24.251%
Region IV	5,263		16.342%
Region V	9,984		31.001%
Nebraska	38,407	100.00%	100.000%

Data Sources:

Mass Layoff Statistics Program July 1, 2012 through March 310, 2013

Rapid Response/WARN Database July 1, 2012 through June 30, 2013

Monthly LMI Managers' Survey July 1, 2012 through June 30 2013

Nebraska Department of Revenue, count of individuals with net earnings less than or equal to \$14,484 on the Schedule F for farm income: IMF/IRTF Extract Year 2010 Schedule F for Tax Year 2009, Department of the Treasury, Internal Revenue Service

Chapter 12 Farm bankruptcies from the US Bankruptcy Court, District of Nebraska calendar year 2013
<http://www.neb.uscourts.gov/pdf/stats.pdf>

Time Period the Data Represent: July 1, 2012 through June 30, 2013

Validity Factor: Good

Fund Allocations
Dislocated Workers

3. Unemployed Individuals

The table below displays the average number of unemployed individuals in each local area and the share of those individuals in each local area and regions of Greater Nebraska.

Local Area	Number of Unemployed Individuals	Percent of State	Percent of Region
Omaha	16,422	40.81%	
Lincoln	6,427	15.97%	
Greater Nebraska	17,392	43.22%	
Region I	1,868		10.741%
Region II	2,272		13.063%
Region III	4,396		25.276%
Region IV	3,439		19.773%
Region V	5,418		31.152%
Nebraska	40,241	100.00%	100.000%

Data Source:

Local Area Unemployment Statistics (LAUS) Program

Time Period the Data Represent: July 1, 2012 through June 30, 2013

Validity Factor: Excellent

4. Jobs Reduced Within Declining Industries

The table below displays the number of jobs reduced in declining industries in each local area and the share in each local area and regions of Greater Nebraska.

Local Area	Jobs Reduced Within Declining Industries	Percent of State	Percent of Region
Omaha	148	41.69%	
Lincoln	0	0.00%	
Greater Nebraska	207	58.31%	
Region I	2		0.9662%
Region 2	0		0.0000%
Region 3	3		1.4493%
Region 4	24		11.5942%
Region 5	178		85.9903%
Nebraska	355	100.00%	100.0000%

Data Sources:

Nebraska Department of Labor, Labor Market Information Center Statewide Short Term Industry Projections for 2012 - 2014

Mass Layoff Statistics Program data for July 1, 2012 through March 31, 2013

Rapid Response/WARN July 1, 2012 through June 30, 2013

Time Period the Data Represent: July 1, 2012 through June 30, 2013

Validity Factor: Excellent

5. Unemployed Individuals in Areas of Concentrated Unemployment

The table below displays the number of unemployed individuals in areas of concentrated unemployment in each local area and the share of those individuals in each local area and regions of Greater Nebraska.

The average unemployment rate in each county was compared with the average unemployment rate for the state. In counties with a higher unemployment rate than the state average, a count of individuals in excess of the state average was taken. In addition, where there are Areas of Substantial Unemployment in a county, the relative number of unemployed individuals who reside in the Area of Substantial Unemployment above the state average was considered and the larger of the excess number of individuals in the county or Area of Substantial Unemployment was taken.

Local Area	Number of Unemployed Individuals in Areas of Concentrated Unemployment	Percent of State	Percent of Region
Omaha #	4,612	60.4456%	
Lincoln	1,374	18.0079%	
Greater Nebraska	1,644	21.5465%	
Region I	300		18.248%
Region II	150		9.124%
Region III	291		17.701%
Region IV	349		21.229%
Region V #	554		33.698%
Nebraska	7,630	100.00%	100.000%

Note: # Includes portions of Northeast Nebraska ASU

Data Source:

Local Area Unemployment Statistics (LAUS) Program and prepared in accordance with the Bureau of Labor Statistics LAUS Technical Memorandum No. S-13-17

Time Period the Data Represent: July 1, 2012 through June 30, 2013

Validity Factor: Excellent

Appendix

Counties with an average unemployment rate higher than the state average are highlighted in salmon.

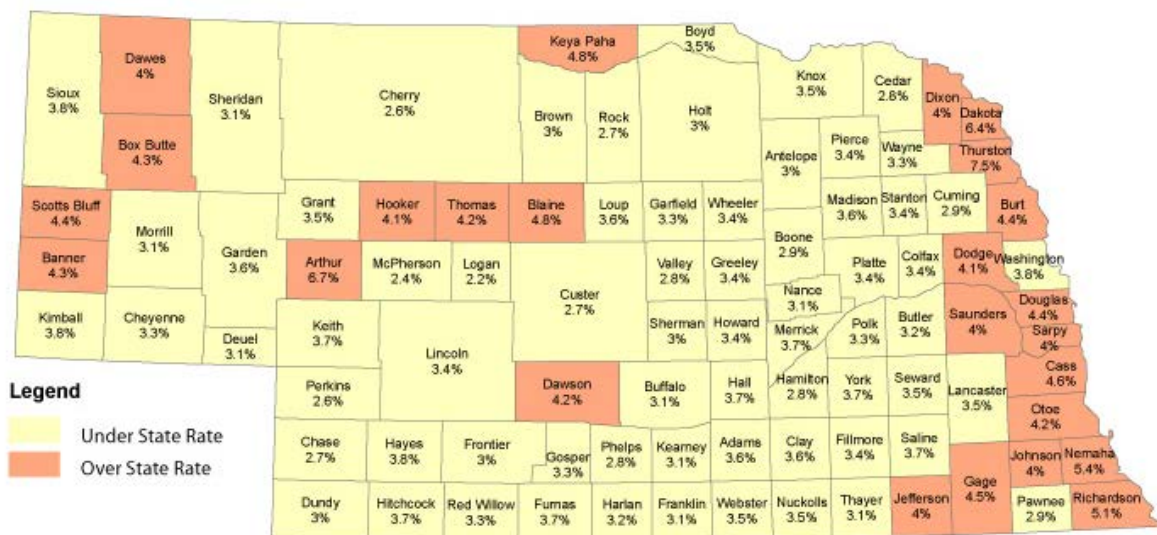

Data Source:

Local Area Unemployment Statistics (LAUS) Program and prepared in accordance with the Bureau of Labor Statistics LAUS Technical Memorandum No. S-13-17

Time Period the Data Represent: July 1, 2012 through June 30, 2013

Validity Factor: Excellent

Omaha –Douglas County Area of Substantial Unemployment Designation Form

Bureau of Labor Statistics Designation of Potential Area of Substantial Unemployment (ASU) <small>This report is authorized by law 28 U.S.C. 2. Your voluntary cooperation is needed to make the results of this survey comprehensive, accurate, and timely. Data are used to verify estimates used by the Employment and Training Administration in fund allocation.</small>	U.S. Department of Labor <small>We estimate that it will take an average of 1 hour to complete this form. If you have any comments regarding these estimates, send them to the Bureau of Labor Statistics, Division of Local Area Unemployment Statistics (1220-0017), 2 Massachusetts Ave., NE, Washington, DC 20212</small>	<small>O.M.B. 1220-0017 Approval expires March 31, 2015. Persons are not required to respond unless this form displays a currently valid DMB control number.</small>
---	---	--

Region 0 5 Date 09/30/2013

State 3 1 ASU Name Douglas County ASU

Area Type (Check one): Labor Market Area ☐ County ☒ City ☐ Contiguous Census Tracts/MCD's ☐ Other ☐

Precise Geographical Definition: 90 tracts in Douglas County: list o
f tracts provided separately.

Preparation Method (Check one): Independent Estimate ☐ Claims/Population ☐ Census Share ☒ Other(specify) _____

Card 1 Census Data:

Employment <u>145,677</u> <small>(10-17)</small>	Unemployment <u>15,558</u> <small>(19-26)</small>	Population <u>296,758</u> <small>(28-36)</small>
---	--	---

If ASU is census shared, enter name and code of area from which ASU is derived.

Name Douglas County, NE Area Code C N 3 1 0 5 5 0
(38-45)

Employment Ratio 0.54848062 Unemployment Ratio 0.81721
(47-54) (56-63)

BLS Use Only Below This Line

ASU Type 2 State Code 3 1 Card 1
(65) (67-68) (80)

Card 2

ASU Code S U 3 1 0 3 0 0 Prep Switch 4
(1-8) (16)

ASU Title Douglas County ASU
(20-73) Card 2 (80)

LAUS-8

Omaha –Douglas County Area of Substantial Unemployment Data Collection Form

Bureau of Labor Statistics

U.S. Department of Labor

Area of Substantial Unemployment (ASU) Data Collection Form

This report is authorized by law 29 U.S.C. 2. Your voluntary cooperation is needed to make the results of this survey comprehensive, accurate, and timely. Data are used to verify estimates used by the Employment and Training Administration in fund allocation.

We estimate that it will take an average of 1 hour to complete this form. If you have any comments regarding these estimates, send them to the Bureau of Labor Statistics, Division of Local Area Unemployment Statistics (1220-0017), 2 Massachusetts Ave., NE, Washington, DC 20212.

O.M.B. 1225-0017
Approval expires March 31, 2015.
Persons are not required to respond unless this form displays a currently valid OMB control Number.

Region: 05

State: 31
FIPS: (1-2)

Date Submitted: 09/30/2013

Area Code : SU310300
(4-12)

ASU Name: Douglas County ASU

Check here if resubmitting data ☐

Year/Month (20-24)	Civilian Labor Force (26-34)	Employment (36-44)	Unemployment (46-54)	Rate (to one decimal place) (56-64)
July 20 12-07	160,188	148,631	11,557	7.2
Aug. 20 12-08	158,447	148,015	10,432	6.6
Sept. 20 12-09	156,018	146,664	9,354	6.0
Oct. 20 12-10	158,598	148,982	9,616	6.1
Nov. 20 12-11	158,003	148,743	9,260	5.9
Dec. 20 12-12	157,086	147,550	9,536	6.1
Jan. 20 13-01	158,631	146,975	11,656	7.3
Feb. 20 13-02	158,898	148,225	10,673	6.7
March 20 13-03	158,354	148,307	10,047	6.3
April 20 13-04	160,624	150,904	9,720	6.1
May 20 13-05	161,044	150,822	10,222	6.3
June 20 13-06	162,922	151,640	11,282	6.9
12 mo. Average	159,068	148,788	10,280	6.5

LAUS 16

Sarpy County Area of Substantial Unemployment

Sarpy County Census Tracts

Census tracts in the Area of Substantial Unemployment are highlighted in green.

Sarpy County ASU (2014)

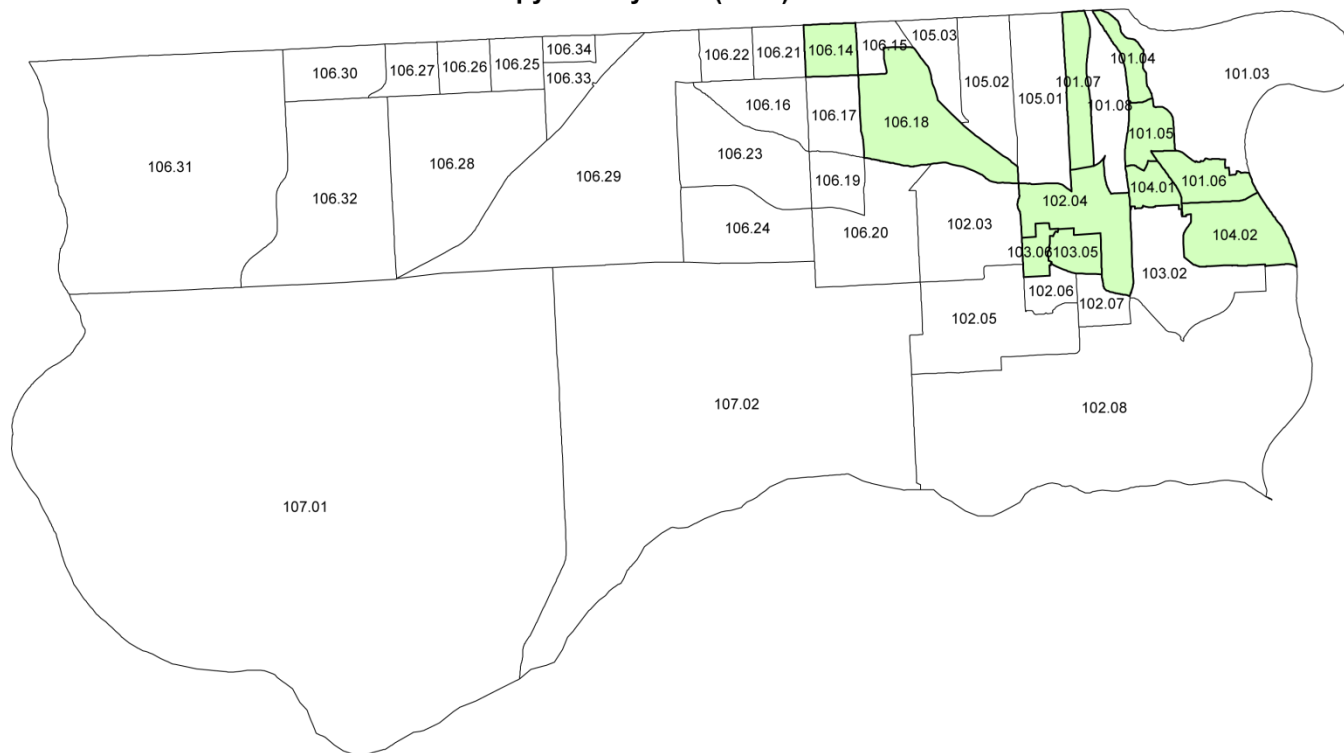

Sarpy County ASU					
010104	010105	010204	010306	010401	010402
010614	010618	010106	010107	010305	

Data Source:

Local Area Unemployment Statistics (LAUS) Program and prepared in accordance with the Bureau of Labor Statistics LAUS Technical Memorandum No. S-13-17

Time Period the Data Represent: July 1, 2012 through June 30, 2013

Validity Factor: Excellent

Sarpy County Area of Substantial Unemployment Designation Form

Bureau of Labor Statistics

U.S. Department of Labor

Designation of Potential Area of Substantial Unemployment (ASU)

This report is authorized by law 29 U.S.C. 2. Your voluntary cooperation is needed to make the results of this survey comprehensive, accurate, and timely. Data are used to verify estimates used by the Employment and Training Administration in fund allocation.

We estimate that it will take an average of 1 hour to complete this form. If you have any comments regarding these estimates, send them to the Bureau of Labor Statistics, Division of Local Area Unemployment Statistics (1220-0217), 2 Massachusetts Ave., NE, Washington, DC 20212

O.M.B. 1220-0217
Approval expires March 31, 2015.
Persons are not required to respond unless this form displays a currently valid OMB control number.

Region

Date 09/30/2013

State

ASU Name Sarpy County ASU

Area Type (Check one): Labor Market Area ☐ County ☒ City ☐ Contiguous Census Tracts/MCD's ☐ Other ☐

Precise Geographical Definition: 11 tracts in Sarpy County: 101.04,1

101.05, 102.04, 103.06, 104.01, 104.02, 106.14, 106.18, 101.06, 101

.07, and 103.05

Preparation Method (Check one): Independent Estimate ☐ Claims/Population ☐ Census Share ☒ Other(specify) _____

Card 1 Census Data:

Employment 17,730 Unemployment 1,533 Population 37,025
(10-17) (19-26) (28-36)

If ASU is census shared, enter name and code of area from which ASU is derived.

Name Sarpy County, NE Area Code
(38-45)

Employment Ratio 0.217894 Unemployment Ratio 0.384133017
(47-54) (56-63)

BLS Use Only Below This Line

ASU Type State Code Card
(65) (67-68) (80)

Card 2

ASU Code Prep Switch
(1-8) (16)

ASU Title Sarpy County ASU

Card
(20-73) (80)

LAUS-8

Sarpy County Area of Substantial Unemployment Data Collection Form

Bureau of Labor Statistics

U.S. Department of Labor

Area of Substantial Unemployment (ASU) Data Collection Form

This report is authorized by law 29 U.S.C. 2. Your voluntary cooperation is needed to make the results of this survey comprehensive, accurate, and timely. Data are used to verify estimates used by the Employment and Training Administration in fund allocation.

We estimate that it will take an average of 1 hour to complete this form. If you have any comments regarding these estimates, send them to the Bureau of Labor Statistics, Division of Local Area Unemployment Statistics (1220-0017), 2 Massachusetts Ave., NE, Washington, DC 20212.

O.M.B. 1220-0017
Approval expires March 31, 2015.
Persons are not required to respond unless this form displays a currently valid OMB control Number.

Region: 05 State: 31 Date Submitted: 09/30/2013
FIPS: (1-2)
Area Code: SU310600 ASU Name: Sarpy County ASU
(4-12)

Check here if resubmitting data ☐

Year/Month (20-24)	Civilian Labor Force (26-34)	Employment (36-44)	Unemployment (46-54)	Rate (to one decimal place) (56-64)
July 20 12-07	19,130	17,720	1,410	7.4
Aug. 20 12-08	18,941	17,646	1,295	6.8
Sept. 20 12-09	18,638	17,485	1,153	6.2
Oct. 20 12-10	18,954	17,762	1,192	6.3
Nov. 20 12-11	18,847	17,733	1,114	5.9
Dec. 20 12-12	18,733	17,591	1,142	6.1
Jan. 20 13-01	18,898	17,522	1,376	7.3
Feb. 20 13-02	18,945	17,671	1,274	6.7
March 20 13-03	18,847	17,681	1,166	6.2
April 20 13-04	19,113	17,991	1,122	5.9
May 20 13-05	19,229	17,981	1,248	6.5
June 20 13-06	19,478	18,078	1,400	7.2
12 mo. Average	18,979	17,738	1,241	6.5

LAUS 16

Lincoln – Lancaster County Area of Substantial Unemployment

Lincoln and Lancaster County Census Tracts

Census tracts in the Area of Substantial Unemployment are highlighted in aqua.

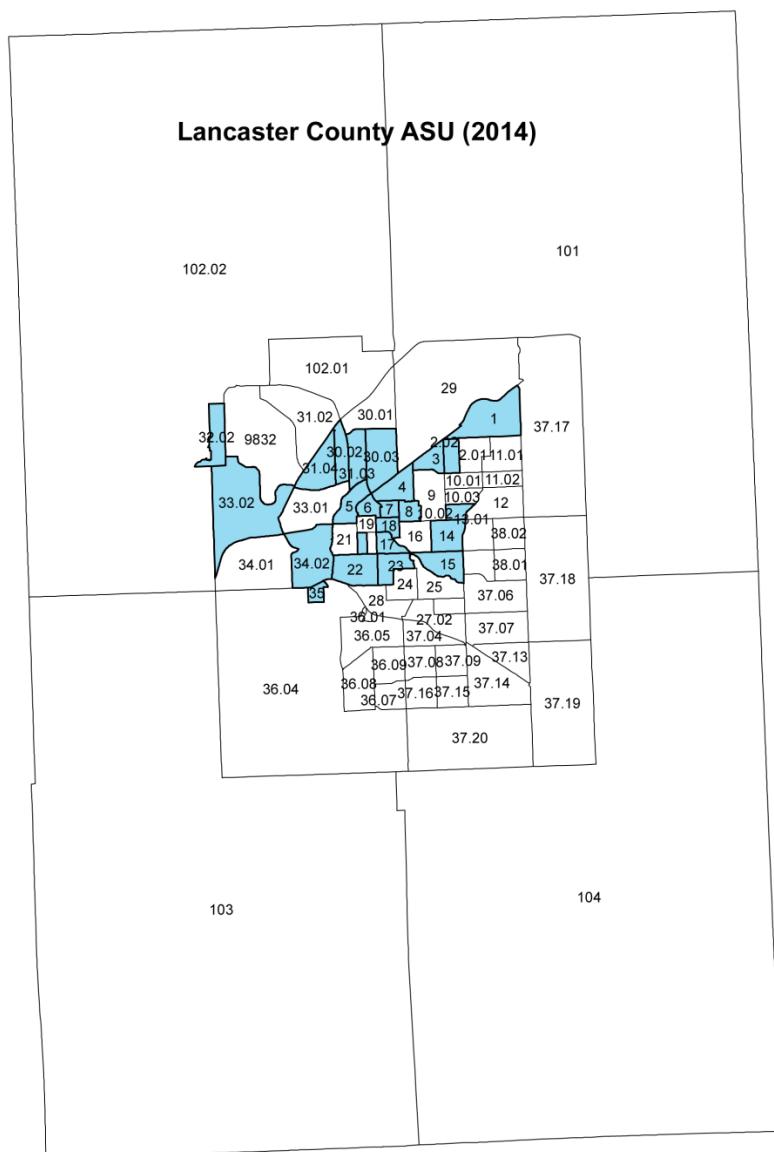

Lincoln City - Lancaster County ASU							
000100	000400	000700	001400	001800	002300	003103	003302
000202	000500	000800	001500	002002	003002	003104	003402
000300	000600	001002	001700	002200	003003	003202	003500

Data Source:

Local Area Unemployment Statistics (LAUS) Program and prepared in accordance with the Bureau of Labor Statistics LAUS Technical Memorandum No. S-13-17

Time Period the Data Represent: July 1, 2012 through June 30, 2013

Validity Factor: Excellent

Lincoln – Lancaster County Area of Substantial Unemployment Designation Form

<p>Bureau of Labor Statistics Designation of Potential Area of Substantial Unemployment (ASU)</p> <p><small>This report is authorized by law 29 U.S.C. 2. Your voluntary cooperation is needed to make the results of this survey comprehensive, accurate, and timely. Data are used to verify estimates used by the Employment and Training Administration in fund allocation.</small></p>	<p>U.S. Department of Labor</p> <p><small>We estimate that it will take an average of 1 hour to complete this form. If you have any comments regarding these estimates, send them to the Bureau of Labor Statistics, Division of Local Area Unemployment Statistics (1220-0017), 2 Massachusetts Ave., NE, Washington, DC 20212</small></p>	<p><small>O.M.B. 1220-0017 Approval expires March 31, 2015. Persons are not required to respond unless this form displays a currently valid OMB control number.</small></p>
--	--	---

Region 0 5 Date 09/30/2013

State 3 1 ASU Name Lancaster County ASU

Area Type (Check one): Labor Market Area ☐ County ☒ City ☐ Contiguous Census Tracts/MCD's ☐ Other ☐

Precise Geographical Definition: 61 tracts in Lancaster County: list
of tracts will be provided separately

Preparation Method (Check one): Independent Estimate ☐ Claims/Population ☐ Census Share ☒ Other(specify) _____

Card 1 Census Data:

Employment <u>46,802</u> (10-17)	Unemployment <u>5,500</u> (18-26)	Population <u>91,550</u> (28-36)
-------------------------------------	--------------------------------------	-------------------------------------

If ASU is census shared, enter name and code of area from which ASU is derived.

Name Lancaster County, NE Area Code C N 3 1 1 0 9 0
 (38-45)

Employment Ratio 0.30354685 Unemployment Ratio 0.57304
 (47-54) (55-63)

BLS Use Only Below This Line

ASU Type 2 State Code 3 1 Card 1
 (65) (67-68) (80)

Card 2

ASU Code S U 3 1 0 1 0 0 Prep Switch 4
 (1-8) (16)

ASU Title Lancaster County ASU Card 2
 (20-73) (80)

LAUS-8

Lincoln – Lancaster Area of Substantial Unemployment Data Collection Form

Bureau of Labor Statistics

U.S. Department of Labor

Area of Substantial Unemployment (ASU) Data Collection Form

This report is authorized by law 29 U.S.C. 2. Your voluntary cooperation is needed to make the results of this survey comprehensive, accurate, and timely. Data are used to verify estimates used by the Employment and Training Administration in fund allocation.

We estimate that it will take an average of 1 hour to complete this form. If you have any comments regarding these estimates, send them to the Bureau of Labor Statistics, Division of Local Area Unemployment Statistics (1220-0017), 2 Massachusetts Ave., NE, Washington, DC 20212.

O.M.B. 1220-0017
Approval expires March 31, 2015.
Persons are not required to respond unless this form displays a currently valid OMB control Number.

Region: 05

State: 31

Date Submitted: 09/30/2013

FIPS: (1-2)

Area Code: SU310100

ASU Name: Lancaster County ASU

(4-12)

Check here if resubmitting data ☐

Year/Month (20-24)	Civilian Labor Force (26-34)	Employment (36-44)	Unemployment (46-54)	Rate (to one decimal place) (56-64)
July 20 12-07	52,217	48,501	3,716	7.1
Aug. 20 12-08	52,096	48,794	3,302	6.3
Sept. 20 12-09	52,055	48,989	3,066	5.9
Oct. 20 12-10	52,639	49,465	3,174	6.0
Nov. 20 12-11	52,584	49,618	2,966	5.6
Dec. 20 12-12	52,410	49,160	3,250	6.2
Jan. 20 13-01	52,901	48,894	4,007	7.6
Feb. 20 13-02	52,873	49,236	3,637	6.9
March 20 13-03	53,076	49,729	3,347	6.3
April 20 13-04	53,565	50,314	3,251	6.1
May 20 13-05	53,772	50,312	3,460	6.4
June 20 13-06	53,739	49,819	3,920	7.3
12 mo. Average	52,828	49,403	3,425	6.5

LAUS 16

Scotts Bluff County Area of Substantial Unemployment

Scottsbluff and Scotts Bluff County Census Tracts

Census tracts in the Area of Substantial Unemployment are highlighted in gold.

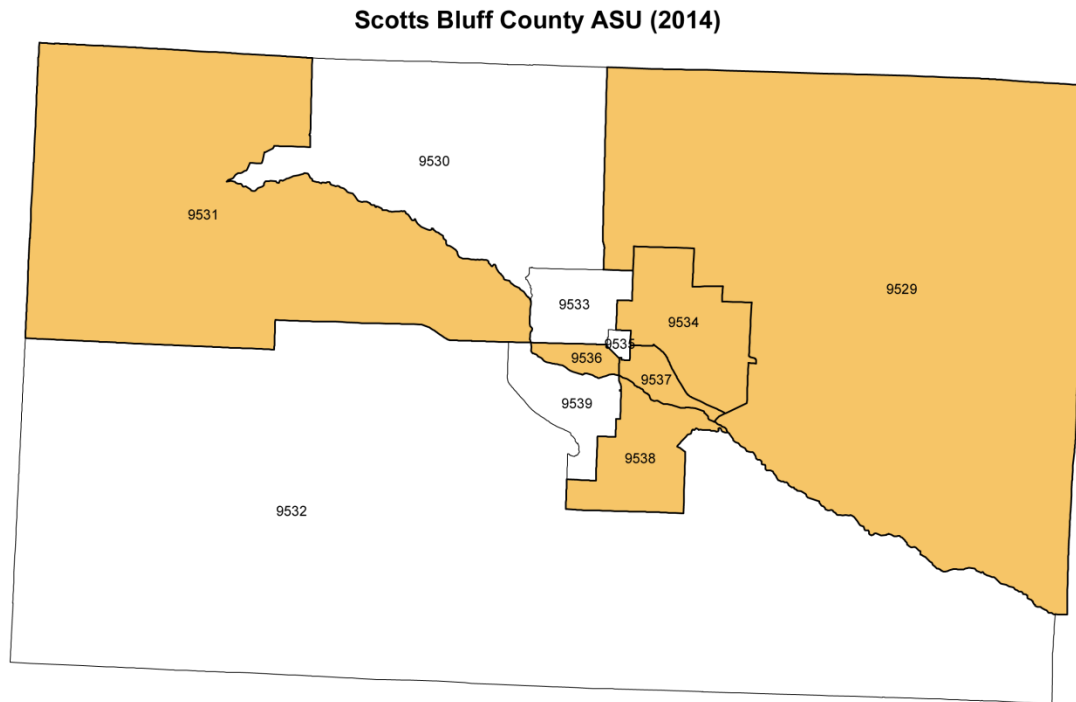

Scotts Bluff County ASU					
952900	953100	953400	953600	953700	953800

Data Source:

Local Area Unemployment Statistics (LAUS) Program and prepared in accordance with the Bureau of Labor Statistics LAUS Technical Memorandum No. S-13-17

Time Period the Data Represent: July 1, 2012 through June 30, 2013

Validity Factor: Excellent

Scotts Bluff County Area of Substantial Unemployment Designation Form

Bureau of Labor Statistics

U.S. Department of Labor

Designation of Potential Area of Substantial Unemployment (ASU)

This report is authorized by law 29 U.S.C. 2. Your voluntary cooperation is needed to make the results of this survey comprehensive, accurate, and timely. Data are used to verify estimates used by the Employment and Training Administration in fund allocation.

We estimate that it will take an average of 1 hour to complete this form. If you have any comments regarding these estimates, send them to the Bureau of Labor Statistics, Division of Local Area Unemployment Statistics (1220-0017), 2 Massachusetts Ave., NE, Washington, DC 20212

O.M.B. 1220-0017
Approval expires March 31, 2015.
Persons are not required to respond unless this form displays a currently valid OMB control number.

Region

Date 09/30/2013

State

ASU Name Scotts Bluff County ASU

Area Type (Check one): Labor Market Area ☐ County ☒ City ☐ Contiguous Census Tracts/MCD's ☐ Other ☐

Precise Geographical Definition: 6 tracts in Scotts Bluff County: 95

2900, 953100, 953400, 953600, 953700, and 953800

Preparation Method (Check one): Independent Estimate ☐ Claims/Population ☐ Census Share ☒ Other(specify) _____

Card 1 Census Data:

Employment 9,074 (10-17) Unemployment 890 (19-26) Population 20,461 (28-36)

If ASU is census shared, enter name and code of area from which ASU is derived.

Name Scotts Bluff County, NE Area Code (38-45)

Employment Ratio 0.50622036 (47-54) Unemployment Ratio 0.7745866 (55-63)

BLS Use Only Below This Line

ASU Type (65) State Code (57-66) Card (80)

Card 2

ASU Code (1-8) Prep Switch (16)

ASU Title Scotts Bluff County ASU

(20-73)

Card

(80)

LAUS-8

Scotts Bluff County Area of Substantial Unemployment Data Collection Form

Bureau of Labor Statistics

U.S. Department of Labor

Area of Substantial Unemployment (ASU) Data Collection Form

This report is authorized by law 29 U.S.C. 2. Your voluntary cooperation is needed to make the results of this survey comprehensive, accurate, and timely. Data are used to verify estimates used by the Employment and Training Administration in fund allocation.

We estimate that it will take an average of 1 hour to complete this form. If you have any comments regarding these estimates, send them to the Bureau of Labor Statistics, Division of Local Area Unemployment Statistics (1220-0017), 2 Massachusetts Ave., NE, Washington, DC 20212.

O.M.B. 1220-0017
Approval expires March 31, 2015.
Persons are not required to respond unless this form displays a currently valid OMB control Number.

Region: 05

State 31
FIPS: 31
(1-2)

Date Submitted: 09/30/2013

Area Code : SU310500
(4-12)

ASU Name: Scotts Bluff County ASU

Check here if resubmitting data ☐

Year/Month (20-24)	Civilian Labor Force (26-34)	Employment (36-44)	Unemployment (46-54)	Rate (to one decimal place) (56-64)
July 20 12-07	10,252	9,524	728	7.1
Aug. 20 12-08	9,947	9,310	637	6.4
Sept. 20 12-09	10,100	9,511	589	5.8
Oct. 20 12-10	10,235	9,613	622	6.1
Nov. 20 12-11	10,168	9,565	603	5.9
Dec. 20 12-12	10,149	9,511	638	6.3
Jan. 20 13-01	10,132	9,371	761	7.5
Feb. 20 13-02	10,166	9,459	707	7.0
March 20 13-03	10,150	9,507	643	6.3
April 20 13-04	10,218	9,588	630	6.2
May 20 13-05	10,283	9,611	672	6.5
June 20 13-06	10,458	9,717	741	7.1
12 mo. Average	10,188	9,524	664	6.5

LAUS 16

Dawson County Area of Substantial Unemployment

Dawson County Census Tracts

Census tracts in the Area of Substantial Unemployment are highlighted in lavender.

Dawson County ASU (2014)

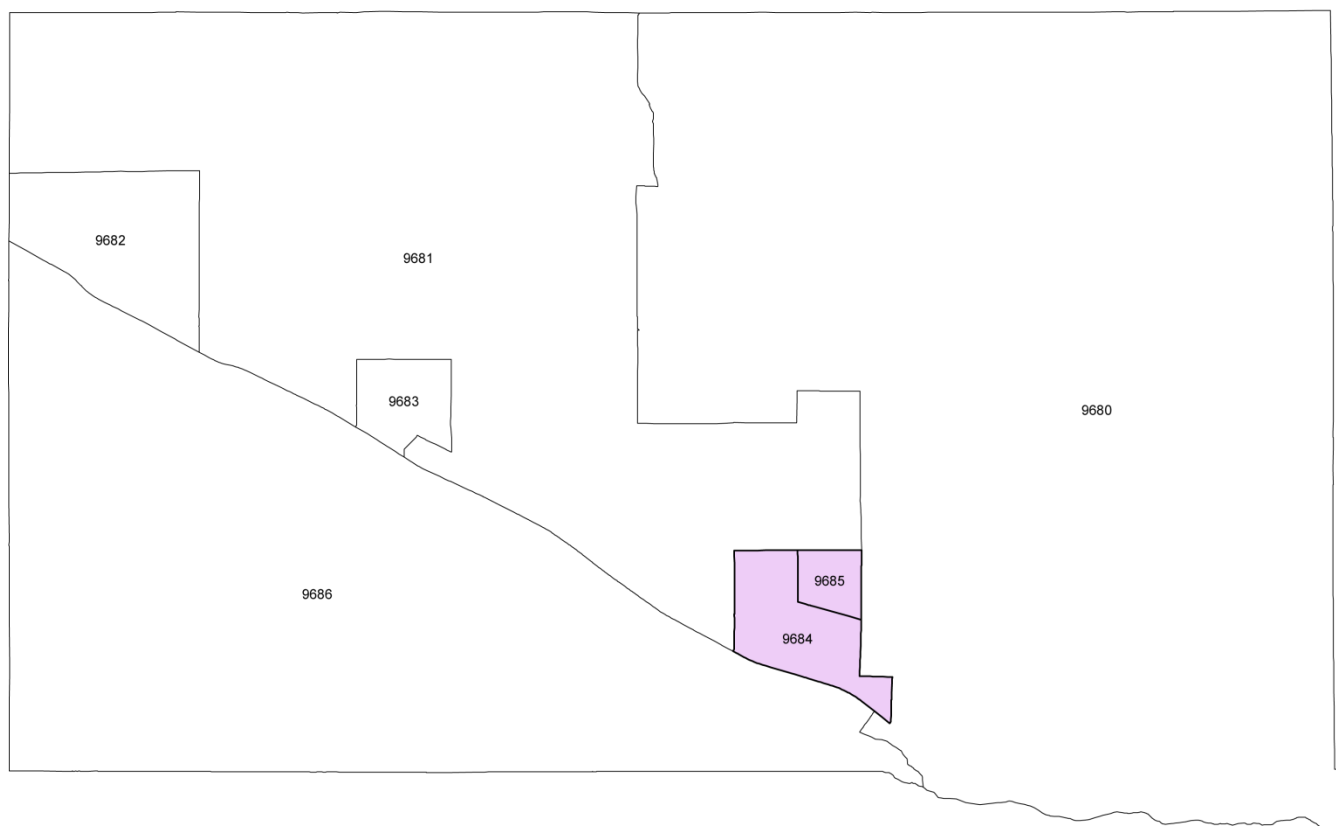

Dawson County ASU	
968400	968500

Data Source:

Local Area Unemployment Statistics (LAUS) Program and prepared in accordance with the Bureau of Labor Statistics LAUS Technical Memorandum No. S-13-17

Time Period the Data Represent: July 1, 2012 through June 30, 2013

Validity Factor: Excellent

Dawson County Area of Substantial Unemployment Designation Form

Bureau of Labor Statistics

U.S. Department of Labor

Designation of Potential Area of Substantial Unemployment (ASU)

This report is authorized by law 29 U.S.C. 2. Your voluntary cooperation is needed to make the results of this survey comprehensive, accurate, and timely. Data are used to verify estimates used by the Employment and Training Administration in fund allocation.

We estimate that it will take an average of 1 hour to complete this form. If you have any comments regarding these estimates, send them to the Bureau of Labor Statistics, Division of Local Area Unemployment Statistics (1220-0017), 2 Massachusetts Ave., NE, Washington, DC 20212

O.M.B. 1220-0017
Approval expires March 31, 2015.
Persons are not required to respond unless this form displays a currently valid OMB control number.

Region

Date 09/30/2013

State

ASU Name Dawson County ASU

Area Type (Check one): Labor Market Area ☐ County ☒ City ☐ Contiguous Census Tracts/MCD's ☐ Other ☐

Precise Geographical Definition: 2 tracts in Dawson County: 968400 &

968500

Preparation Method (Check one): Independent Estimate ☐ Claims/Population ☐ Census Share ☒ Other(specify) _____

Card 1 Census Data:

Employment 5,042
(10-17)

Unemployment 435
(19-26)

Population 10,789
(28-36)

If ASU is census shared, enter name and code of area from which ASU is derived.

Name Dawson County, NE

Area Code
(38-45)

Employment Ratio 0.415458141
(47-54)

Unemployment Ratio 0.651197605
(56-63)

BLS Use Only Below This Line

ASU Type
(65)

State Code
(67-68)

Card
(80)

Card 2

ASU Code
(1-8)

Prep Switch
(16)

ASU Title Dawson County ASU

(20-73)

Card

(80)

LAUS-8

Dawson County Area of Substantial Unemployment Data Collection Form

Bureau of Labor Statistics

U.S. Department of Labor

Area of Substantial Unemployment (ASU) Data Collection Form

This report is authorized by law 28 U.S.C. 2. Your voluntary cooperation is needed to make the results of this survey comprehensive, accurate, and timely. Data are used to verify estimates used by the Employment and Training Administration in fund allocation.

We estimate that it will take an average of 1 hour to complete this form. If you have any comments regarding these estimates, send them to the Bureau of Labor Statistics, Division of Local Area Unemployment Statistics (1220-0017), 2 Massachusetts Ave., NE, Washington, DC 20212.

O.M.B. 1220-0017
Approval expires March 31, 2015.
Persons are not required to respond unless this form displays a currently valid OMB control Number.

Region: 05

State 31
FIPS: (1-2)

Date Submitted: 09/30/2013

Area Code : SU310400
(4-12)

ASU Name: Dawson County ASU

Check here if resubmitting data ☐

Year/Month (20-24)	Civilian Labor Force (26-34)	Employment (36-44)	Unemployment (46-54)	Rate (to one decimal place) (56-64)
July 20 12-07	5,502	5,137	365	6.6
Aug. 20 12-08	5,398	5,055	343	6.4
Sept. 20 12-09	5,424	5,096	328	6.0
Oct. 20 12-10	5,420	5,090	330	6.1
Nov. 20 12-11	5,401	5,058	343	6.4
Dec. 20 12-12	5,437	5,068	369	6.8
Jan. 20 13-01	5,416	4,995	421	7.8
Feb. 20 13-02	5,407	5,016	391	7.2
March 20 13-03	5,372	5,035	337	6.3
April 20 13-04	5,374	5,074	300	5.6
May 20 13-05	5,363	5,040	323	6.0
June 20 13-06	5,454	5,083	371	6.8
12 mo. Average	5,414	5,062	352	6.5

LAUS 16

Buffalo County Area of Substantial Unemployment

Buffalo County Census Tracts

Census tracts in the Area of Substantial Unemployment are highlighted in light blue.

Buffalo County ASU (2014)

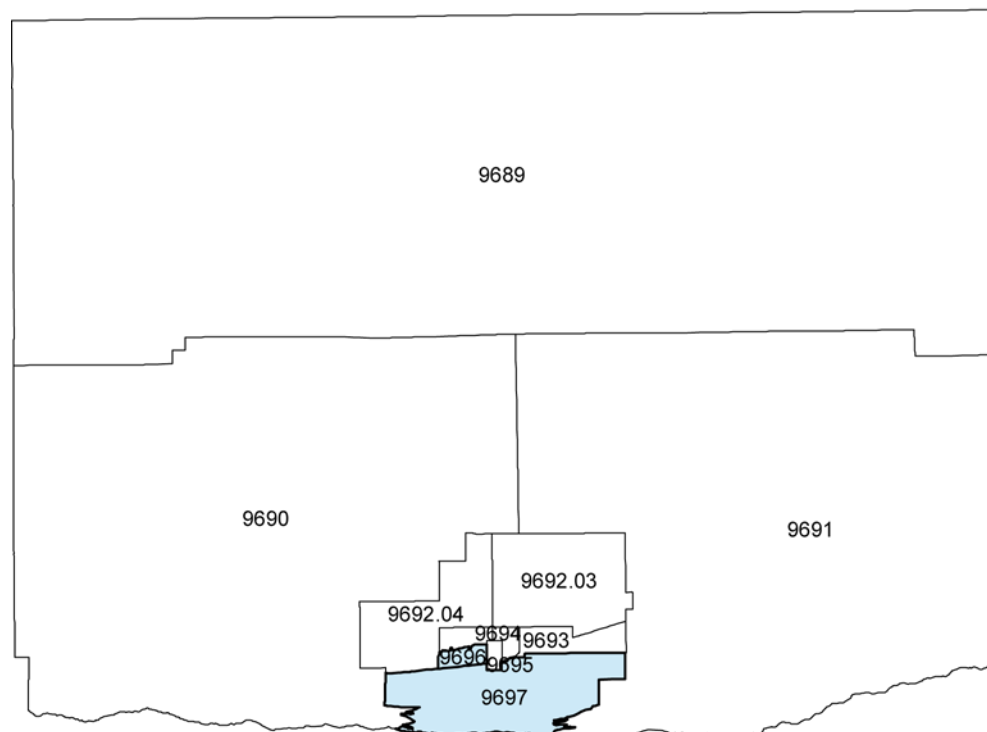

Buffalo County ASU	
969600	969700

Data Source:

Local Area Unemployment Statistics (LAUS) Program and prepared in accordance with the Bureau of Labor Statistics LAUS Technical Memorandum No. S-13-17

Time Period the Data Represent: July 1, 2012 through June 30, 2013

Validity Factor: Excellent

Buffalo County Area of Substantial Unemployment Designation Form

<p>Bureau of Labor Statistics</p> <p>Designation of Potential Area of Substantial Unemployment (ASU)</p> <p><small>This report is authorized by law 29 U.S.C. 2. Your voluntary cooperation is needed to make the results of this survey comprehensive, accurate, and timely. Data are used to verify estimates used by the Employment and Training Administration in fund allocation.</small></p>	<p>U.S. Department of Labor</p> <p><small>We estimate that it will take an average of 1 hour to complete this form. If you have any comments regarding these estimates, send them to the Bureau of Labor Statistics, Division of Local Area Unemployment Statistics (1220-0017), 2 Massachusetts Ave., NE, Washington, DC 20212</small></p>	<p><small>O.M.B. 1220-0017</small></p> <p><small>Approval expires March 31, 2015.</small></p> <p><small>Persons are not required to respond unless this form displays a currently valid OMB control number.</small></p>
---	--	---

Region Date 09/30/2013

State ASU Name Buffalo County ASU

Area Type (Check one): Labor Market Area ☐ County ☒ City ☐ Contiguous Census Tracts/MCD's ☐ Other ☐

Precise Geographical Definition: 2 tracts in Buffalo County: 969600,

969700

Preparation Method (Check one): Independent Estimate ☐ Claims/Population ☐ Census Share ☒ Other(specify) _____

Card 1 Census Data:

Employment <u>6,354</u> (10-17)	Unemployment <u>629</u> (19-26)	Population <u>11,431</u> (28-36)
------------------------------------	------------------------------------	-------------------------------------

If ASU is census shared, enter name and code of area from which ASU is derived.

Name Buffalo County, NE Area Code
(38-45)

Employment Ratio <u>0.25206284</u> (47-54)	Unemployment Ratio <u>0.5581189</u> (56-63)
---	--

BLS Use Only Below This Line

ASU Type <input type="text" value="2"/> (65)	State Code <input type="text" value="3"/> <input type="text" value="1"/> (67-68)	Card <input type="text" value="1"/> (80)
---	---	---

Card 2

ASU Code <input type="text" value="S"/> <input type="text" value="U"/> <input type="text" value="3"/> <input type="text" value="1"/> <input type="text" value="1"/> <input type="text" value="0"/> <input type="text" value="0"/> <input type="text" value="0"/> (1-8)	Prep Switch <input type="text" value="4"/> (16)
---	--

ASU Title Buffalo County ASU

Card
(80)

LAUS-6

Buffalo County Area of Substantial Unemployment Data Collection Form

Bureau of Labor Statistics

U.S. Department of Labor

Area of Substantial Unemployment (ASU) Data Collection Form

This report is authorized by law 29 U.S.C. 2. Your voluntary cooperation is needed to make the results of this survey comprehensive, accurate, and timely. Data are used to verify estimates used by the Employment and Training Administration in fund allocation.

We estimate that it will take an average of 1 hour to complete this form. If you have any comments regarding these estimates, send them to the Bureau of Labor Statistics, Division of Local Area Unemployment Statistics (1220-0017), 2 Massachusetts Ave., NE, Washington, DC 20012.

O.M.B. 1220-0017
Approval expires March 31, 2015.
Persons are not required to respond unless this form displays a currently valid OMB control number.

Region: 05

State: 31
FIPS: (1-2)

Date Submitted: 09/30/2013

Area Code: SU311000

(4-12)

ASU Name: Buffalo County ASU

Check here if resubmitting data ☐

Year/Month (20-24)	Civilian Labor Force (26-34)	Employment (36-44)	Unemployment (46-54)	Rate (to one decimal place) (56-64)
July 20 12-07	7,598	7,041	557	7.3
Aug. 20 12-08	7,396	6,931	465	6.3
Sept. 20 12-09	7,476	7,061	415	5.6
Oct. 20 12-10	7,557	7,118	439	5.8
Nov. 20 12-11	7,474	7,061	413	5.5
Dec. 20 12-12	7,485	7,015	470	6.3
Jan. 20 13-01	7,519	6,933	586	7.8
Feb. 20 13-02	7,577	7,038	539	7.1
March 20 13-03	7,573	7,079	494	6.5
April 20 13-04	7,653	7,165	488	6.4
May 20 13-05	7,703	7,173	530	6.9
June 20 13-06	7,716	7,104	612	7.9
12 mo. Average	7,561	7,060	501	6.6

LAUS 16

Southeast Nebraska Area of Substantial Unemployment

Johnson, Nemaha and Richardson County Census Tracts

Census tracts in the Area of Substantial Unemployment are highlighted in pink.

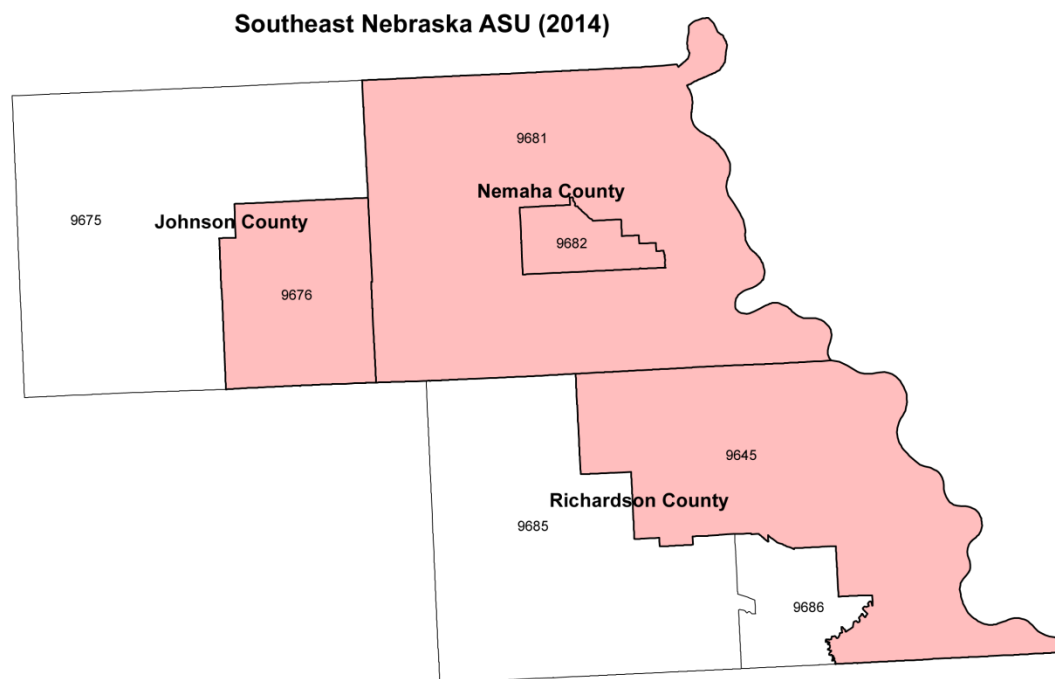

Southeast Nebraska ASU			
967600	968100	968200	964500

Data Source:

Local Area Unemployment Statistics (LAUS) Program and prepared in accordance with the Bureau of Labor Statistics LAUS Technical Memorandum No. S-13-17

Time Period the Data Represent: July 1, 2012 through June 30, 2013

Validity Factor: Excellent

Southeast Nebraska Area of Substantial Unemployment Designation Form

Bureau of Labor Statistics		U.S. Department of Labor	
Designation of Potential Area of Substantial Unemployment (ASU)			
This report is authorized by law 29 U.S.C. 2. Your voluntary cooperation is needed to make the results of this survey comprehensive, accurate, and timely. Data are used to verify estimates used by the Employment and Training Administration in fund allocation.		We estimate that it will take an average of 1 hour to complete this form. If you have any comments regarding these estimates, send them to the Bureau of Labor Statistics, Division of Local Area Unemployment Statistics (1220-G017), 2 Massachusetts Ave., NE, Washington, DC 20212	
O.M.B. 1220-G017 Approval expires March 31, 2013. Persons are not required to respond unless this form displays a currently valid OMB control number.			

Region 0 5	Date <u>09/30/2013</u>
State 3 1	ASU Name <u>Southeast ASU</u>

Area Type (Check one): Labor Market Area ☐ County ☒ City ☐ Contiguous Census Tracts/MCD's ☐ Other ☐

Precise Geographical Definition: Census tracts from SU310701 Johnson

Part, SU310702 Nemaha Part, and SU310703 Richardson Part: 96760

0, 968100, 968200, 964500

Preparation Method (Check one): Independent Estimate ☐ Claims/Population ☐ Census Share ☐ Other(specify) _____

Card 1 Census Data:

Employment <u>5,481</u> (10-17)	Unemployment <u>497</u> (19-25)	Population <u>12,229</u> (28-36)
------------------------------------	------------------------------------	-------------------------------------

If ASU is census shared, enter name and code of area from which ASU is derived.

Name _____ Area Code
(38-45)

Employment Ratio _____ Unemployment Ratio _____
(47-54) (56-63)

BLS Use Only Below This Line

ASU Type 2 (65)	State Code 3 1 (67-68)	Card 1 (80)
--	---	--

Card 2

ASU Code S U 3 1 0 7 0 0 (1-8)	Prep Switch 7 (16)
---	---

ASU Title Southeast ASU

_____ Card 2
(20-73) (80)

LAUS-8

Southeast Nebraska Area of Substantial Unemployment Data Collection Form

Bureau of Labor Statistics

U.S. Department of Labor

Area of Substantial Unemployment (ASU) Data Collection Form

This report is authorized by law 29 U.S.C. 2. Your voluntary cooperation is needed to make the results of this survey comprehensive, accurate, and timely. Data are used to verify estimates used by the Employment and Training Administration in fund allocation.

We estimate that it will take an average of 1 hour to complete this form. If you have any comments regarding these estimates, send them to the Bureau of Labor Statistics, Division of Local Area Unemployment Statistics (1220-0017), 2 Massachusetts Ave., NE, Washington, DC 20012.

O.M.B. 1220-0017
Approval expires March 31, 2015.
Persons are not required to respond unless this form displays a correctly valid OMB control Number.

Region: 05

State
FIPS: 31
(1-2)

Date Submitted: 09/30/2013

Area Code : SU310700
(4-12)

ASU Name: Southeast ASU

Check here if resubmitting data ☐

Year/Month (20-24)	Civilian Labor Force (26-34)	Employment (36-44)	Unemployment (46-54)	Rate (to one decimal place) (56-64)
July 20 12-07	5,920	5,478	442	7.5
Aug. 20 12-08	5,815	5,441	374	6.4
Sept. 20 12-09	6,021	5,674	347	5.8
Oct. 20 12-10	6,078	5,732	346	5.7
Nov. 20 12-11	6,007	5,702	305	5.1
Dec. 20 12-12	6,065	5,716	349	5.8
Jan. 20 13-01	6,033	5,578	455	7.5
Feb. 20 13-02	6,098	5,680	418	6.9
March 20 13-03	6,104	5,720	384	6.3
April 20 13-04	6,134	5,766	368	6.0
May 20 13-05	6,180	5,761	419	6.8
June 20 13-06	6,148	5,665	483	7.9
12 mo. Average	6,050	5,659	391	6.5

LAUS 16

Northeast Nebraska Area of Substantial Unemployment

Dakota, Thurston, Burt, Dodge and Washington County Census Tracts

Census tracts in the Area of Substantial Unemployment are highlighted in orange.

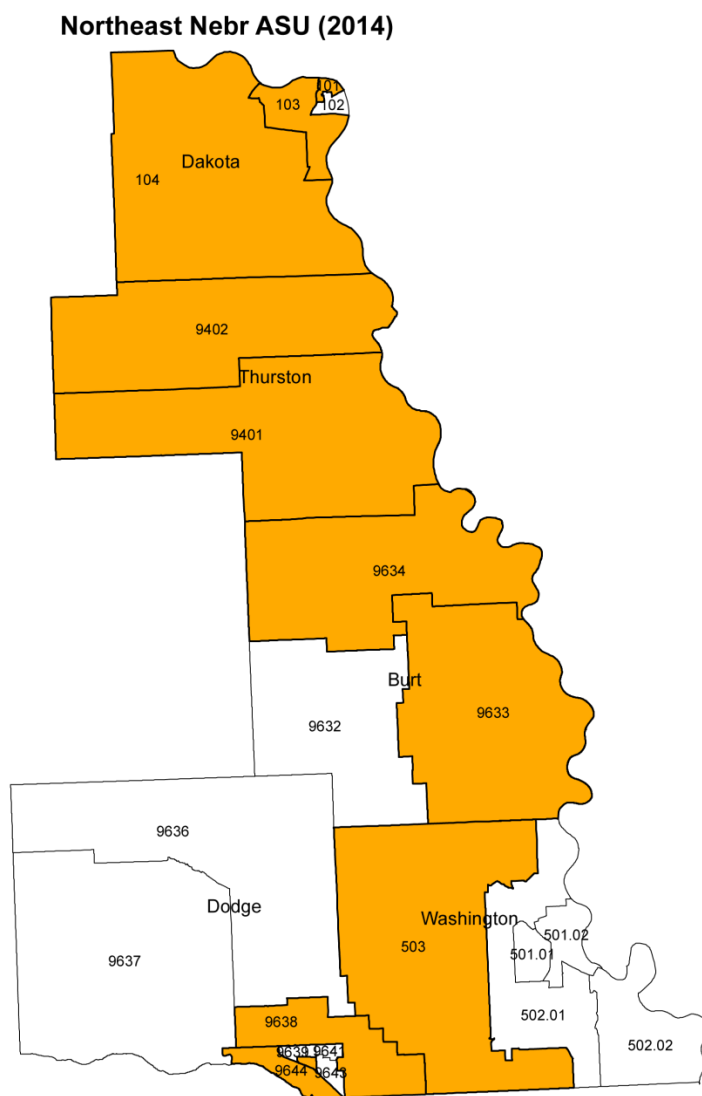

Northeast Nebraska ASU					
963300	963400	010100	010300	010400	963800
964200	964400	940100	940200	050300	

Data Source:

Local Area Unemployment Statistics (LAUS) Program and prepared in accordance with the Bureau of Labor Statistics LAUS Technical Memorandum No. S-13-17

Time Period the Data Represent: July 1, 2012 through June 30, 2013

Validity Factor: Excellent

Northeast Nebraska Area of Substantial Unemployment Designation Form

Bureau of Labor Statistics

U.S. Department of Labor

Designation of Potential Area of Substantial Unemployment (ASU)

This report is authorized by law 29 U.S.C. 2. Your voluntary cooperation is needed to make the results of this survey comprehensive, accurate, and timely. Data are used to verify estimates used by the Employment and Training Administration in fund allocation.

We estimate that it will take an average of 1 hour to complete this form. If you have any comments regarding these estimates, send them to the Bureau of Labor Statistics, Division of Local Area Unemployment Statistics (1220-0017), 2 Massachusetts Ave., NE, Washington, DC 20212

O.M.B. 1220-0017
Approval expires March 31, 2015.
Persons are not required to respond unless this form displays a currently valid OMB control number.

Region

Date 09/30/2013

State

ASU Name Northeast ASU

Area Type (Check one): Labor Market Area ☐ County ☒ City ☐ Contiguous Census Tracts/MCD's ☐ Other ☐

Precise Geographical Definition: 11 tracts SU310801 Burt Co Part, SU

310802 Dakota Co Part, SU310803 Fremont MC Part, SU310804 Thurston

n Co Part, SU310805 Washington Co Part: 963300, 963400, 010100,

010300, 010400, 963800, 964200, 964400, 940100, 940200, 950300

Preparation Method (Check one): Independent Estimate ☐ Claims/Population ☐ Census Share ☐ Other(specify) Addition

Card 1 Census Data:

Employment 20,099 (10-17) Unemployment 1,661 (18-26) Population 43,045 (28-36)

If ASU is census shared, enter name and code of area from which ASU is derived.

Name _____ Area Code (38-45)

Employment Ratio _____ (47-54) Unemployment Ratio _____ (56-63)

BLS Use Only Below This Line

ASU Type (65) State Code (67-68) Card (80)

Card 2

ASU Code (1-8) Prep Switch (16)

ASU Title Northeast ASU

(20-73)

Card

(80)

LAUS-B

Northeast Nebraska Area of Substantial Unemployment Data Collection Form

Bureau of Labor Statistics

U.S. Department of Labor

Area of Substantial Unemployment (ASU) Data Collection Form

This report is authorized by law 28 U.S.C. 2. Your voluntary cooperation is needed to make the results of this survey comprehensive, accurate, and timely. Data are used to verify estimates used by the Employment and Training Administration in fund allocation.

We estimate that it will take an average of 1 hour to complete this form. If you have any comments regarding these estimates, send them to the Bureau of Labor Statistics, Division of Local Area Unemployment Statistics (1220-0017), 2 Massachusetts Ave., NE, Washington, DC 20212.

O.M.B. 1220-0017
Approval expires March 31, 2013.
Persons are not required to respond unless this form displays a currently valid OMB control number.

Region: 05

State: 31
FIPS: (1-2)

Date Submitted: 09/30/2013

Area Code : SU310800
(4-12)

ASU Name: Northeast ASU

Check here if resubmitting data ☐

Year/Month (20-24)	Civilian Labor Force (26-34)	Employment (36-44)	Unemployment (46-54)	Rate (to one decimal place) (56-64)
July 20 12-07	23,133	21,447	1,686	7.3
Aug. 20 12-08	22,675	21,217	1,458	6.4
Sept. 20 12-09	22,583	21,275	1,308	5.8
Oct. 20 12-10	22,944	21,591	1,353	5.9
Nov. 20 12-11	22,829	21,521	1,308	5.7
Dec. 20 12-12	22,770	21,428	1,342	5.9
Jan. 20 13-01	23,079	21,277	1,802	7.8
Feb. 20 13-02	23,081	21,428	1,653	7.2
March 20 13-03	23,023	21,558	1,465	6.4
April 20 13-04	23,350	21,842	1,508	6.5
May 20 13-05	23,302	21,832	1,470	6.3
June 20 13-06	23,565	21,958	1,607	6.8
12 mo. Average	23,028	21,531	1,497	6.5

LAUS 16

Madison County Area of Substantial Unemployment

Madison County Census Tracts

Census tracts in the Area of Substantial Unemployment are highlighted in green.

Madison County ASU (2014)

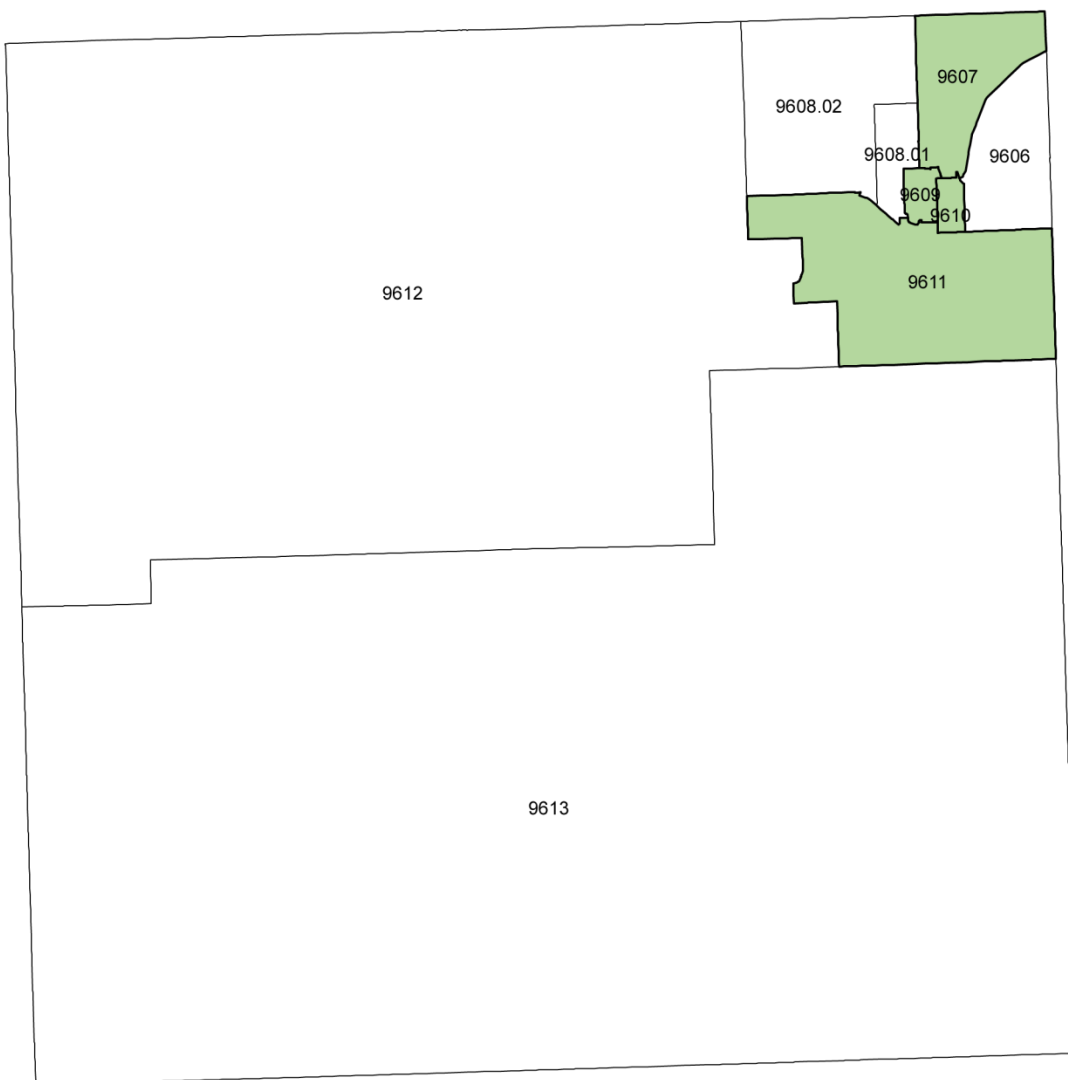

Madison County ASU			
960700	960900	961000	961100

Data Source:

Local Area Unemployment Statistics (LAUS) Program and prepared in accordance with the Bureau of Labor Statistics LAUS Technical Memorandum No. S-13-17

Time Period the Data Represent: July 1, 2012 through June 30, 2013

Validity Factor: Excellent

Madison County Area of Substantial Unemployment Designation Form

Bureau of Labor Statistics

U.S. Department of Labor

Designation of Potential Area of Substantial Unemployment (ASU)

This report is authorized by law 29 U.S.C. 2. Your voluntary cooperation is needed to make the results of this survey comprehensive, accurate, and timely. Data are used to verify estimates used by the Employment and Training Administration in fund allocation.

We estimate that it will take an average of 1 hour to complete this form. If you have any comments regarding these estimates, send them to the Bureau of Labor Statistics, Division of Local Area Unemployment Statistics (1220-0017), 2 Massachusetts Ave., NE, Washington, DC 20212

O.M.B. 1220-0017
Approval expires March 31, 2015.
Persons are not required to respond unless this form displays a currently valid OMB control number.

Region

Date 09/30/2013

State

ASU Name Madison County ASU

Area Type (Check one): Labor Market Area ☐ County ☒ City ☐ Contiguous Census Tracts/MCD's ☐ Other ☐

Precise Geographical Definition: 4 tracts in Madison County: 960700,

960900, 961000, 961100

Preparation Method (Check one): Independent Estimate ☐ Claims/Population ☐ Census Share ☒ Other(specify) _____

Card 1 Census Data:

Employment 6,514 (10-17) Unemployment 517 (19-26) Population 12,784 (28-36)

If ASU is census shared, enter name and code of area from which ASU is derived.

Name Madison County, NE Area Code (38-45)

Employment Ratio 0.3558785 (47-54) Unemployment Ratio 0.67142857 (56-63)

BLS Use Only Below This Line

ASU Type (65) State Code (67-68) Card (80)

Card 2

ASU Code (1-8) Prep Switch (16)

ASU Title Madison County ASU

(20-73)

Card

(80)

LAUS-8

Madison County Area of Substantial Unemployment Data Collection Form

Bureau of Labor Statistics

U.S. Department of Labor

Area of Substantial Unemployment (ASU) Data Collection Form

This report is authorized by law 29 U.S.C. 2. Your voluntary cooperation is needed to make the results of this survey comprehensive, accurate, and timely. Data are used to verify estimates used by the Employment and Training Administration in fund allocation.

We estimate that it will take an average of 1 hour to complete this form. If you have any comments regarding these estimates, send them to the Bureau of Labor Statistics, Division of Local Area Unemployment Statistics (1220-0017), 2 Massachusetts Ave., NE, Washington, DC 20212.

O.M.B. 1220-0017
Approval expires March 31, 2015.
Persons are not required to respond unless the form displays a currently valid OMB control Number.

Region: 05

State: 31
FIPS: (1-2)

Date Submitted: 09/30/2013

Area Code : SU310900
(4-12)

ASU Name: Madison County ASU

Check here if resubmitting data ☐

Year/Month (20-24)	Civilian Labor Force (26-34)	Employment (36-44)	Unemployment (46-54)	Rate (to one decimal place) (56-64)
July 20 12-07	7,242	6,720	522	7.2
Aug. 20 12-08	7,128	6,683	445	6.2
Sept. 20 12-09	7,220	6,814	406	5.6
Oct. 20 12-10	7,253	6,824	429	5.9
Nov. 20 12-11	7,178	6,774	404	5.6
Dec. 20 12-12	7,211	6,765	446	6.2
Jan. 20 13-01	7,258	6,691	567	7.8
Feb. 20 13-02	7,245	6,727	518	7.1
March 20 13-03	7,233	6,755	478	6.6
April 20 13-04	7,232	6,804	428	5.9
May 20 13-05	7,270	6,788	482	6.6
June 20 13-06	7,389	6,857	532	7.2
12 mo. Average	7,238	6,767	471	6.5

LAUS 16